



The Scout Centre

Maximum capacity during the day: 140 people

Maximum capacity overnight: 40 people

40 people included in the price of Scout Centre hire

- Fully equipped kitchen—see next page
- Large 6 burner cooker with oven, double sink and drainer, hand wash sink, fridge, freezer, hot water burco, kettle and microwave
- Food cupboards and work surfaces
- Versatile large main room with tables and chairs. Please keep these inside the building
- One bunk room (sleeps 12) with mattresses. Own bedding required
- Side room which can be converted into two smaller rooms
- One leader room with two single beds
- Dedicated indoor toilets and showers (separate male and female) plus one disabled access toilet with own shower
- Hot water is supplied via a hot water tank. When completely drained, it takes approximately 30 minutes to refill and reheat
- Storage heaters make it suitable for use throughout the year. Heating is currently disabled from April to September to conserve energy and cost
- Please familiarise yourself with the Scout Centre rules

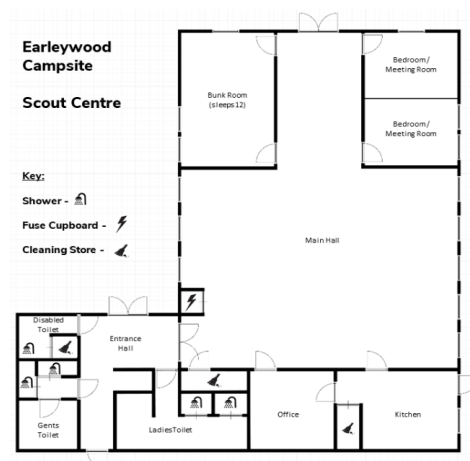



Kitchen

Microwave	Toast racks
Fridge (leave switched off when not in use)	Teapots
Freezer (leave switched off when not in use)	Trays
2 Kettles	50 mugs
Urn	60 cups
Double sink	36 x forks, knives, spoons
Handwash only sink	36 x teaspoons
Large oven	40 x bowls
6 ring hob	40 x large plates
Fire blanket	40 x small plates
Fire extinguisher	Sieve
Saucepans—2 large, 4 medium, 4 small	Toaster
5 frying pans	Extractor fan
9 Jugs	12 baking trays
6 large bowls	Rolling pin
2 Colanders	3 pan stands
Knives—3 small, 3 large	Oven gloves
40 plastic cups	Mop and bucket
6 pairs of scissors	First aid kit
2 tin openers	Washing up liquid
2 bottle openers	Washing up bowls
Peeler	Washing up rack
2 spaghetti spoons	2 x Dustpan and brush
2 large slotted spoons	Bin
2 small slotted spoons	Cupboard storage
6 Chopping boards	1 broom
2 ladles	Cleaning materials
4 tongs	
4 fish slices	
2 whisks	
2 graters	
2 potato mashers	

Toilets

Gents—2 toilets, 2 urinals, 3 sinks, 2 showers
Ladies—3 toilets, 4 sinks, 2 showers
Disabled toilet—toilet, sink, shower, assistance bars and handles, cleaning cupboard

Entrance Hall

Coat hooks
Shoe/boot rack
Fire extinguisher

Main Hall

4 x Fire extinguishers
Cleaning cupboard with cleaning materials
9 comfy chairs
Dividers/room partitions
Small table
TV, remote, cable (need to bring own speakers)
Table football
10 large tables
98 folding chairs
Hot water switch (please leave off when not in use)

Bunk Room

6 bunk beds (12 beds) with mattresses

Side Room

Divider to split the room into two

Leaders' Room— lockable

2 single beds with mattresses
Chair
2 bedside tables and lamps



BUILDING RULES – ALL USERS

SCOUT CENTRE

- Always consult your own risk assessment before you start any activities in the building.
- No ball games are allowed in the Scout Centre.
- Tables & Chairs **MUST NOT** be removed from the Scout Centre and taken outside for any reason. There is plenty of outdoor furniture for your use.
- In order to keep the building clean, please ensure all outdoor footwear is removed.
- General waste and recycling bins are located outside the Scout Centre. Please make sure all waste is removed from buildings and camping pitches at the end of your visit.
- Ensure that all taps and lights are turned off as well as the heating and hot water switch before you depart.
- The building must be left clean and tidy, hoovers are provided.
- Please do not leave ANY food in cupboards or fridges.
- The kitchen comes fully equipped so please check that you have not removed any kitchen equipment by mistake.

Please report any problems, concerns, damage to Earleywood via email when you leave
bookings@earleywood.org.uk